

VAUGHAN

Stirling Swing Arm Wall Light

WA0289

US Version



| | |
|----------------------|----------------|
| Height | 5¾" |
| Width | 23¾" |
| Depth | 23¼" |
| Weight | 4.4 lbs |
| Material | Brass |
| Bulb Quantity | x1 |
| Input Voltage | 120V |
| Dimmable | Mains Dimmable |

Recommended Shade

| | |
|-------------------|--------------|
| Shade Shown | 12" Pembroke |
| Height with Shade | 14" |
| Width with Shade | 27½" |
| Depth with Shade | 27½" |

Finishes

| | |
|--------|--------------|
| Brass | WA0289.BR.US |
| Bronze | WA0289.BZ.US |

Bulb Specification

| | |
|--------------------|------------------|
| Bulb Base | E26 Medium Base |
| Max Wattage | 100W |
| Bulb Supplied | No |
| Vaughan Recommends | LED/2700K/500 lm |

For a brighter light, a bulb with a higher lumen output can be used.

Further Information

All dimensions given are with arms at maximum extension.

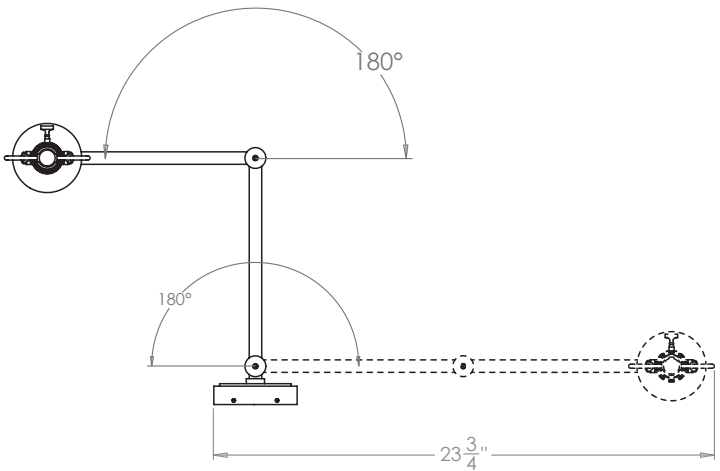
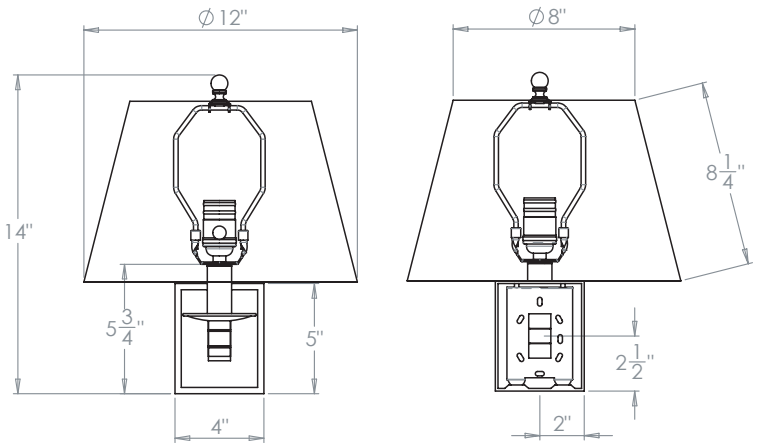

Please Note:- These notes are for guidance only. Vaughan accepts no responsibility for any installation using the above notes. The final decision on installation remains with the installer.