



Height	5¾"
Width	12"
Depth	10"
Weight	0.66lbs
Material	Brass
Bulb Quantity	Built in LED Module
Input Voltage	120V
Dimmable	Non-Dimmable

Finishes

Light Bronze

WA0342.LB.US

Bulb Specification

Light Source

Built In LED Module

2700K / 800 lm

AC Wattage

7W,

DC Current

120mA CC

Further Information

Integral LED units are supplied fitted with this product and are not replaceable.

May be attached to wall or picture. Supplied with a separate driver. (see diagram on right)

Cord length from picture light fitting to driver is 3.3' cord length from driver to the plug is 9.8'. The product is supplied with a spare plug so that the cable to be shortened.

Also available in 16" (WA0343), 20" (WA0344) and 24" (WA0345).

Product Class: Class II

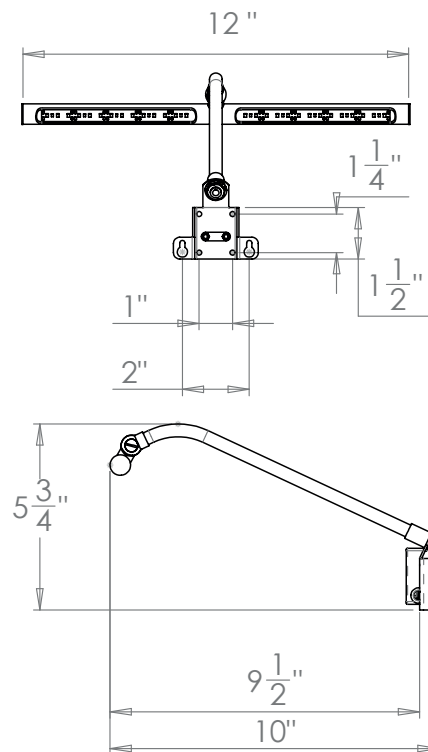

Driver Dimensions

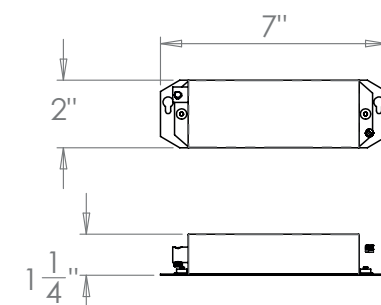

Please Note:- These notes are for guidance only. Vaughan accepts no responsibility for any installation using the above notes. The final decision on installation remains with the installer.